

ONLINE UPS  
1-3kVA  
Single Phase / Single Phase

# Powerpack Prime Series

Servers and Other  
Networking Equipment



- ① RS232 Port
- ② Intelligent Slot
- ③ Fan
- ④ Output Socket
- ⑤ Breaker
- ⑥ AC Input

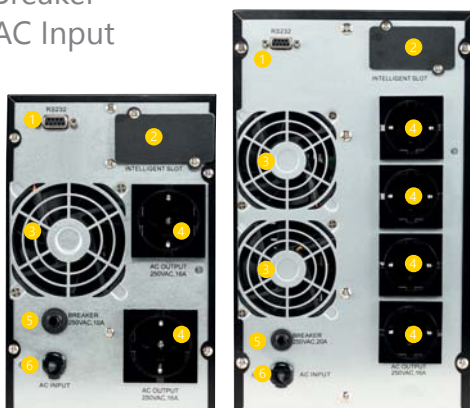

- True Double-Conversion Design with High Adaptability to Harsh Mains Conditions
- DSP design Enables Precise and Reliable Control
- High Efficiency Results in Energy Saving
- Output Power Factor 0.8 (up to 0.9 under 30°C)
- Wide AC Input Range (110-300Vac)
- Automatic Switching Between 50/60Hz System
- Precise Voltage Regulation ( $\pm 1\%$ )
- Supports AC Generator
- Supports DC Start-up and Auto Restart
- Intelligent Communication Slot Enables Remote Monitoring

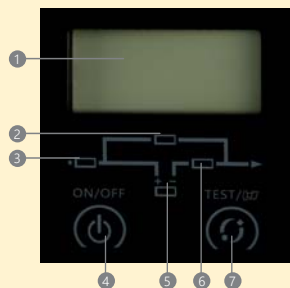

- ① LCD Display
- ② Bypass Led
- ③ Mains Led
- ④ ON / OFF Button
- ⑤ Battery Led
- ⑥ Inverter Led
- ⑦ Test Button

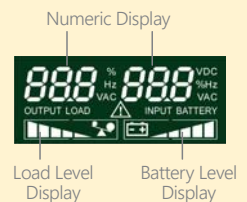

1kVA • 2kVA • 3kVA

MODEL			
Capacity	1000VA / 800W	2000VA / 1600W	3000VA / 2400W
INPUT			
Input Voltage Range	110~300Vac		
Frequency Range	40-70Hz		
Input Wiring	Single Phase with Ground		
Current Distortion (THD)	<10%		
OUTPUT			
Output Power Factor	0.8		
Nominal Output Voltage	200 <sup>1</sup> /208 <sup>2</sup> /220/230/240 Vac		
Voltage Regulation	±2%		
Frequency Range (Battery Mode)	50/60 ±0.05 Hz		
Current Crest Ratio	2.95:1		
Voltage Distortion (THDv)	<4% @ linear load, <7% @ non-linear load		
Output Waveform	Pure Sine Wave		
Parallel Operation	N/A		
EFFICIENCY			
Inverter Mode	>89%	>90%	
Battery Mode	>83%	>83%	>83%
ECO Mode	N/A		
BATTERY			
Battery Type	12V/45W		
Number of Internal Battery	2	4	6
Rated Battery Voltage	24Vdc	48Vdc	72Vdc
Backup Time (@ Full Load)	4.5 min	4.5 min	4.5 min
Recharge Time (to 90%)	7 hours	7 hours	7 hours
Charging Current (max)	1A	1A	1A
TRANSFER TIME			
Battery Mode ↔ Inverter Mode	0ms		
Inverter Mode ↔ Bypass Mode	4ms		
PHYSICAL			
Display	LCD		
Audible Alarm	Yes		
Dimension (WxDxH) (mm)	144 x 345 x 229	190 x 393 x 328	
Net Weight (kg)	9.2	17.2	22.6
ENVIRONMENTAL			
Operating Temperature	0°C~40°C		
Noise Level	< 45 dB	< 50 dB	
INTERFACE			
RS232	Yes		
External Slot	Yes		
Emergency Power Off	No		

Makelsan reserves the right to change or modify product design, construction, specifications, or materials without prior notice and without incurring any obligation to make such changes and modifications on Makelsan products previously or subsequently sold. Makelsan does not guarantee the items of the accuracy and completeness.

Note:  
1. 200Vac will be subject to 80% output derating  
2. 208Vac will be subject to 80% output derating